



GD Midea Commercial Air-conditioning Equipment Co., Ltd.

Add: Midea Industrial City, Shunde, Foshan, Guangdong, 528311, P.R.China

Tel: +86-757-26339642 Fax: +86-757-26339337

E-mail: [mcac@midea.com.cn](mailto:mcac@midea.com.cn)

[Http://www.midea.com.cn](http://www.midea.com.cn)

[Http://www.mdvchina.com](http://www.mdvchina.com) (customer service)



# Midea Air Conditioners

Commercial Aircon System 50Hz

# Midea Creates A Better Life

**No.1**  
Air Conditioner Export in China



Midea produced its first Air Conditioner in 1984. Currently we are the industry leader for Air conditioner manufacturing and export. Midea has been exporting Air Conditioners for the last 16 years, and during this time has cultivated strong partnerships with hundreds of overseas companies.



We provide Global technical training and a comprehensive online customer service. All of our customers from over 110 countries and regions receive top quality service at all times.



Our vertically integrated supply chain allows us to achieve maximum efficiency in production and product development.

The year of 1999 has witnessed Midea's entry into the field of commercial air conditioner. The leading-edged technology, state-of-art assembly lines, and years' of experience in air conditioner field have made Midea as the leader in the field of commercial air conditioner in China.



Nowadays, Midea can offer the fullest range of commercial air conditioner in China. It consists of Multi Digital Variable System: Digital scroll A/C system, Inverter commercial A/C system; Light Chiller System: Mini air-cooled chiller system, Modular air-cooled chiller system, Water-cooled Packaged unit, Heating water system; Commercial Chiller System: Screw chiller system, Centrifugal chiller system.

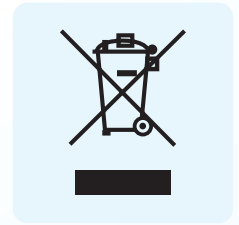

# Full Range of R410A Digital Scroll A/C System

## Feature of R410A system

Friendly Refrigerant, save energy and protect environment

Good performance of cooling & heating.

The component of the R410A is close to azeotropy, with little change of the component structure, the capability will not decrease during the recharge period.

Do not contain the element Chlorine, protect the ozonosphere

R410A

R410A

## Basic modules



5 basic modules: 8HP, 10HP, 12HP, 14HP, 16HP

2HP increments of capacity



Basic modules

## Free combination, wide range

5 basic modules, which can be freely assembled.

2HP increments of capacity range, which meets customers' needs accurately;

Maximum capacity is 64HP.



# Intelligent Built-in Manager System

Intelligent Manager is an integrated building management system(BMS) that uses our independent, high-speed multi-transmission method. It has a centralized controller function that can perform high-speed centralized control of our commercial A/C for buildings.

MDV system has various control solutions:

Individual control, Group control, Network control, etc.

1 computer can monitor max 16 central controllers.

1 central controller can monitor max 64 indoor units.

1 computer can monitor max 1024 indoor units.

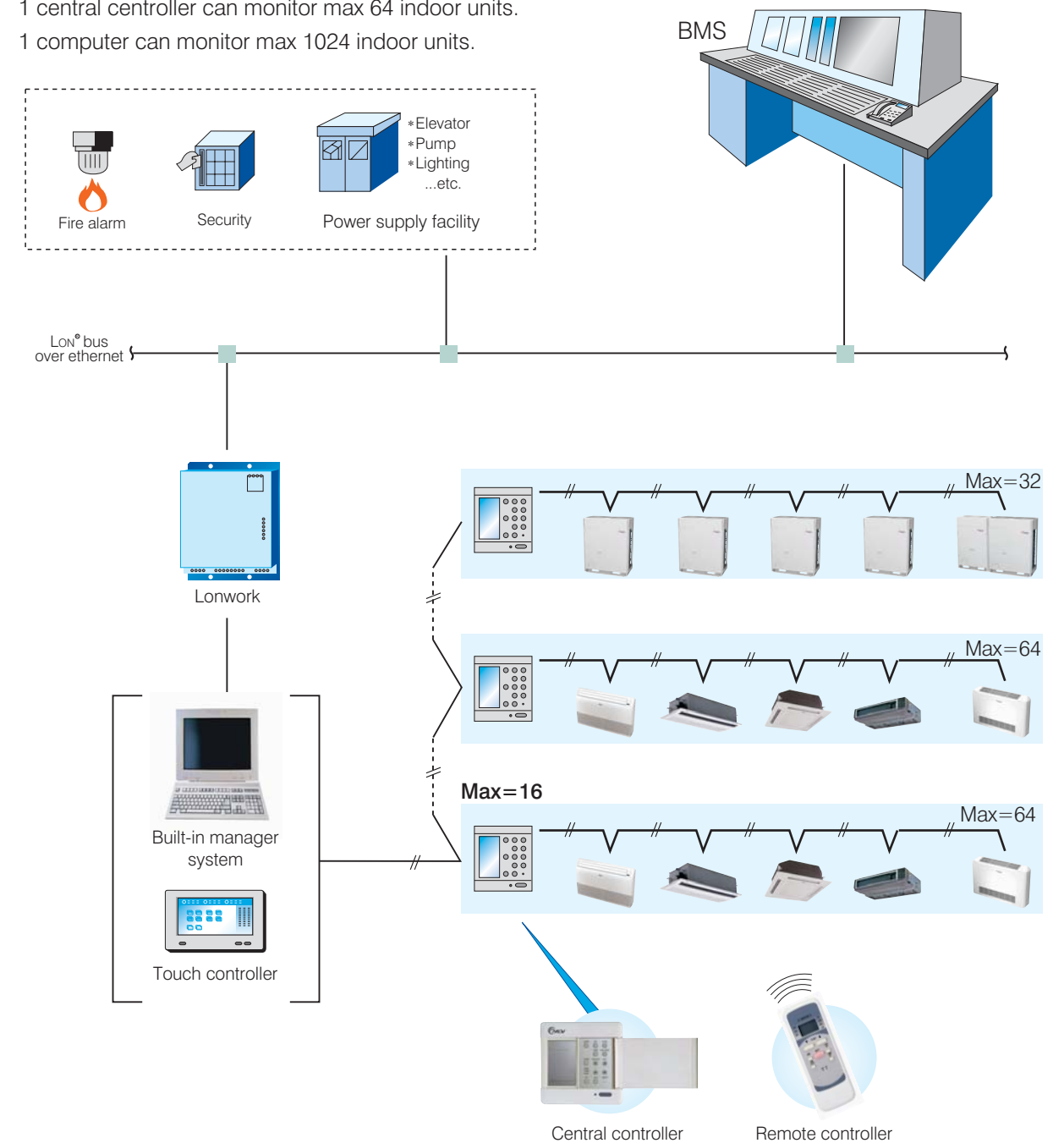

# Intelligent Built-in Manager System

## Independent Calculating System

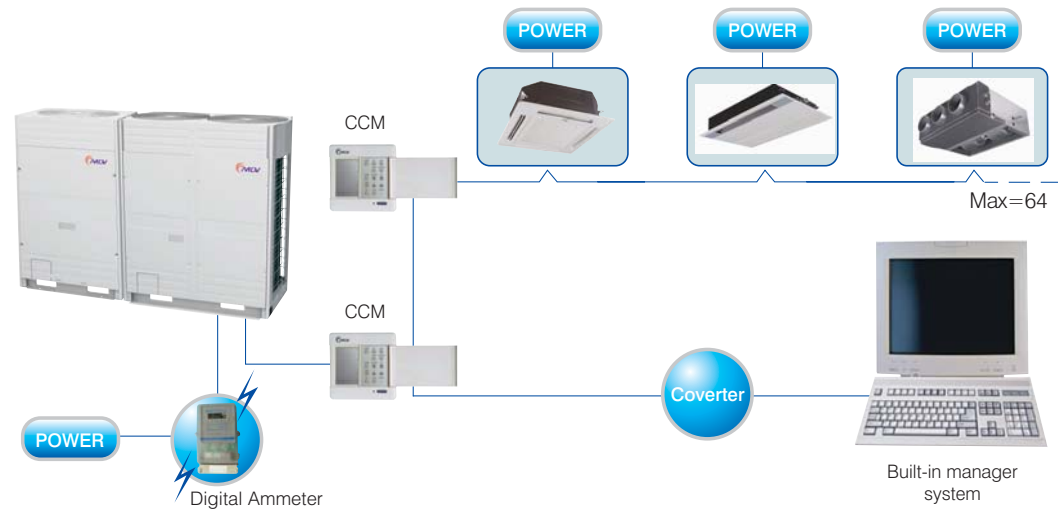

## Independent calculation Report

Independent calculation and output with report, easy to know the charge of the A/C.

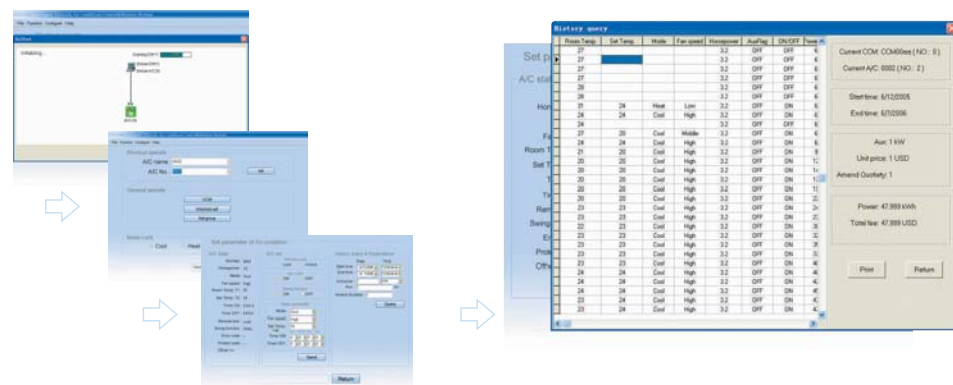

## Group setting, simple and efficient.

One group consists of on-line A/Cs in different Central controllers, maximum 1024 units. One system can be set by 16 groups to manage a huge A/C system. The group setting can control each on-line unit, unionize them to be On / Off or change the parameters. It's so convenient and easy.



## Schedule setting, no need to worry during the operation of A/C

With the advanced Schedule setting mode, the PC can easily manage the daily work of A/C. The system can set the weekly plan of A/C and operate automatically in cycle.



# Model selection software

## Windows version

Operate directly on Windows interface; friendlier interface makes its applicable range much wider. Main functions includes load calculation, multi-split and chilled water system selection, explicit quotation table output, hydraulic calculation, capacity inquire with changeable outdoor environment (for multi-split) or nonstandard working criteria (for chiller), etc. Update with product change.



## CAD version

Two versions each compatible with AutoCAD 2000/2002 and AutoCAD 2004/2005. Professional software that helps engineers design project easily, quickly and conveniently. Main functions include load calculation, equipment selection, pipeline setting, system figure configuration, quotation table automatic output, refrigerant volume calculation, wiring and installation diagram output, etc. Update with product change.

# 2007 Midea Commercial A/C Model Line Up

## [ D ] Digital Scroll A/C System

R410A R407C R22

29-43



## [ V ] Inverter A/C System (DC/AC)

R410A R22

44-49



## [ M ] Multi Variable A/C System

R407C R22

50-52



## [ H ] Multi System

R410A R407C R22

53-62



## [ R ] Heating Water System

R407C R22

63-67



## Accessories

68-76

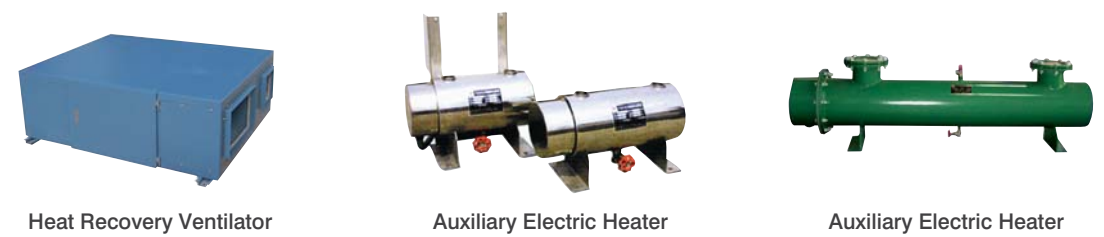

# Digital Scroll A/C System

## Operation Principle Of Digital Scroll Compressor

- The digital scroll compressor which utilizes the axial compliant sealing technology precisely adjust the axial moving range of the stator scroll pan. And there is an additional connecting by-pass between the suction inlet and the pressure bore at the floating sealing point of axial stator.
- When the PWM solenoid valve is open, the pressure in the pressure bore is released. The pressure in the compression bore is higher than that top of the stator, then the stator axis of the compressor will move upward a little. So high pressure bore and low pressure inlet is connected and the unloading is achieved.
- When the PWM solenoid valve is closed, two stators engaged. Then the airproof and loading is achieved. The compressor can adjust the ratio of ONs to OFFs freely to control the refrigerant output of the compressor.

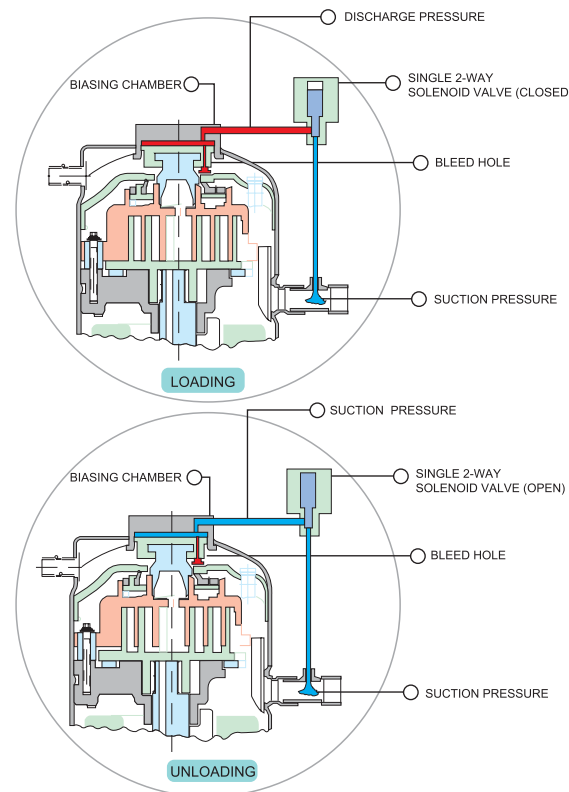

## No electromagnetic Disturbance

- MDV Digital Scroll System causes no electromagnetic disturbance, since the loading and unloading of compressor are merely mechanical movements. This special feature makes the Digital Scroll System applicable to telecommunication companies, power stations, and all kinds of precise science labs.

Electromagnetic Comparison Between Digital And Inverter

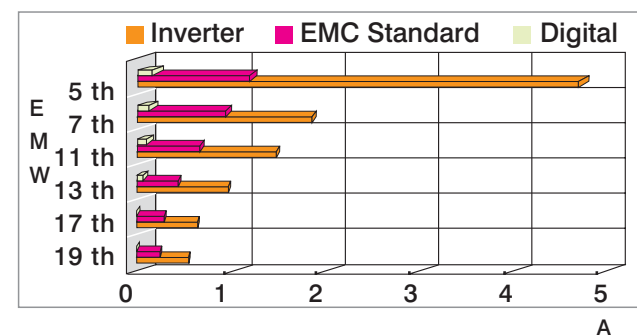

Precise Science Lab



Communication Computer Lab



TV & Radio Receiver Station

## Advanced Oil Return Technology

- The Digital Scroll Compressor is in the state of loading or unloading. In the loading state, the full speed operation of the compressor motor ensures the refrigerant has enough power to bring the oil back to the compressor. In the unloading state, there is no oil moving out of the compressor since there is no refrigerant output, the inertia of the refrigerant can also bring some oil back to the compressor.
- Combining the electronic control and the mechanical control, the oil level controller keeps an appropriate oil level in the compressor crankcase. Equipped with alarm system, it is applicable to both low-pressure & high pressure oil cycling system.

## Accurate Temperature Control

- Compared with the traditional central air conditioning system, MDV System can reach a 0.5 Degree Centigrade accuracy.

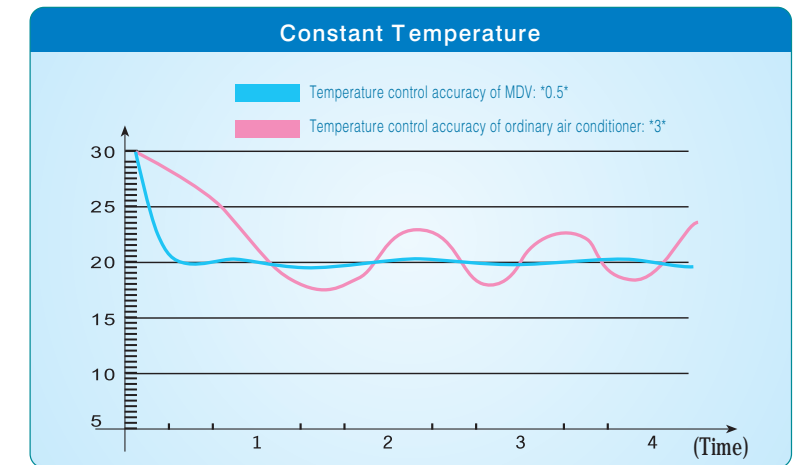

## Long pipe, wide height difference

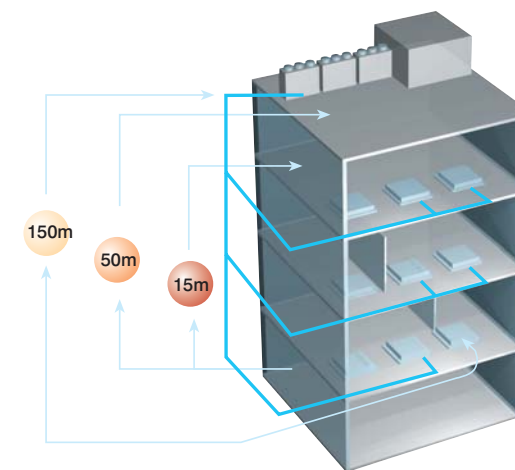





- Digital scroll system is the only system that is free of oil separator and oil recycling equipment. In the loading status, the speed of the refrigerant is enough to move oil back to the compressor. In the unloading status, no refrigerant pump out, no oil out of compressor.

- 150m the max. pipe length between indoor unit and outdoor unit
- 50m the max. height difference between indoor unit and outdoor unit
- 15m the max. height difference between indoor units

# Digital Scroll A/C System

Cooling & Heating

## Outdoor Unit

	Capacity(HP)	Model	Combination	Indoor unit connected
	8	MDV-D252W/CS(N2)(N1)	8	13
	10	MDV-D280W/CS(N2)(N1)	10	16
	12	MDV-D335W/CS(N2)(N1)	12	16
	14	MDV-D400W/CS(N2)(N1)	14	16
	16	MDV-D450W/CS(N2)(N1)	16	20
	18	MDV-D532W/CS(N2)(N1)	8+10	20
	20	MDV-D560W/CS(N2)(N1)	10+10	20
	22	MDV-D615W/CS(N2)(N1)	10+12	20
	24	MDV-D680W/CS(N2)(N1)	10+14	20
	26	MDV-D730W/CS(N2)(N1)	10+16	20
	28	MDV-D785W/CS(N2)(N1)	12+16	20
	30	MDV-D850W/CS(N2)(N1)	14+16	32
	32	MDV-D900W/CS(N2)(N1)	16+16	32
	34	MDV-D960W/CS(N2)(N1)	10x2+14	32
	36	MDV-D1010W/CS(N2)(N1)	10x2+16	32
	38	MDV-D1065W/CS(N2)(N1)	10+12+16	32
	40	MDV-D1130W/CS(N2)(N1)	10+14+16	40
	42	MDV-D1180W/CS(N2)(N1)	10+16x2	40
	44	MDV-D1235W/CS(N2)(N1)	12+16x2	40
	46	MDV-D1300W/CS(N2)(N1)	14+16x2	40
	48	MDV-D1350W/CS(N2)(N1)	16x3	40
		50	MDV-D1405W/CS(N2)(N1)	12x3+14
52		MDV-D1455W/CS(N2)(N1)	12x3+16	50
54		MDV-D1520W/CS(N2)(N1)	12x2+14+16	50
56		MDV-D1570W/CS(N2)(N1)	12x2+16x2	50
58		MDV-D1630W/CS(N2)(N1)	10+16x3	50
60		MDV-D1685W/CS(N2)(N1)	12+16x3	64
62		MDV-D1750W/CS(N2)(N1)	14+16x3	64
64		MDV-D1800W/CS(N2)(N1)	16x4	64

## Outdoor Unit

R410A



Model	MDV-D252W/CSN1	MDV-D280W/CSN1	MDV-D335W/CSN1	MDV-D400W/CSN1	MDV-D450W/CSN1
<b>Capacity</b>					
Cooling	kW	25.2	28.0	33.5	40.0
Heating	kW	27.0	31.5	35.0	43.0
<b>Electrical Data</b>					
Voltage, Frequency, Phase	V-, Hz, Ph	380, 50, 3	←	←	←
<b>Performance</b>					
Air Flow Volume	m <sup>3</sup> /h	10000	←	←	14000
Noise Level	dB(A)	58	←	←	60
<b>Dimension</b>					
Net	WxHxD	mm	980x1630x800	←	←
Packing	WxHxD	mm	1040x1780x840	←	←
<b>Weight</b>					
Net	kg	245	←	←	396
Gross	kg	260	←	←	416
<b>Piping Connection</b>					
Max Length of pipe		175	←	←	←
Max Height Difference Between indoor units		15	←	←	←
Between indoor units and outdoor unit		50	←	←	←
<b>SystemMatch Configuration</b>					
Max Qty per 20'/40'/40'HQ	Pieces	1-drive-13 14/28/28	1-drive-16 ←	←	←
				8/16/16	1-drive-20 ←

## Outdoor Unit

R407C

R22



Model	MDV-D252W/CS(N2)	MDV-D280W/CS(N2)	MDV-D335W/CS(N2)	MDV-D400W/CS(N2)	MDV-D450W/CS(N2)
<b>Capacity</b>					
Cooling	kW	25.2	28.0	33.5	40.0
Heating	kW	27.0	31.5	35.0	43.0
<b>Electrical Data</b>					
Voltage, Frequency, Phase	V-, Hz, Ph	380, 50, 3	←	←	←
<b>Performance</b>					
Air Flow Volume	m <sup>3</sup> /h	14000	←	←	←
Noise Level	dB(A)	60	←	←	←
<b>Dimension</b>					
Net	WxHxD	mm	1380x1630x830	←	←
Packing	WxHxD	mm	1440x1800x860	←	←
<b>Weight</b>					
Net	kg	327	←	←	396
Gross	kg	347	←	←	416
<b>Piping Connection</b>					
Max Length of pipe		150	←	←	←
Max Height Difference Between indoor units		15	←	←	←
Between indoor units and outdoor unit		50	←	←	←
<b>SystemMatch Configuration</b>					
Max Qty per 20'/40'/40'HQ	Pieces	1-drive-13 8/16/16	1-drive-16 ←	←	←
				←	1-drive-20 ←

Remarks: 1.The above specifications are subject to change without prior notice for product improvement.  
2.The noise levels given in the table reflect the levels in anechoic chamber.

# Digital Scroll A/C System

Cooling & Heating

## Outdoor Unit

R410A



Model	MDV-D100W(S)N1	MDV-D140W/SN1	MDV-D280W/BSN1
Capacity			
Cooling kW	10.0	14.0	28.0
Heating kW	11.0	16.0	31.5
<b>Electrical Data</b>			
Voltage, Frequency, Phase	V-, Hz, Ph	220-240, 50, 1(380, 50, 3)	380, 50, 3
<b>Performance</b>			
Air Flow Volume	m <sup>3</sup> /h	5000	6000
Noise Level	dB(A)	54	55
<b>Dimension</b>			
Net Packing	WxHxD mm	990x960x360	940x1245x340
Weight	mm	1120x1090x435	1058x1377x435
Net	kg	101	110
Gross	kg	106	125
<b>Piping Connection</b>			
Max Length of pipe		60	←
Max Height Difference	Between indoor units	8	←
	Between indoor units and outdoor units	20	←
<b>SystemMatch Configuration</b>			
Max Qty per 20'/40'/40'HQ	Pieces	1-drive-6 50/100/100	1-drive-8 30/62/62

## Outdoor Unit

R407C

R22



Model	MDV-D100W/SN2	MDV-D100W/(N2)	MDV-D140W/S(N2)	MDV-D280W/BS(N2)	MDV-D560W/BS(N2)	MDV-D840W/BS(N2)
Capacity						
Cooling kW	10.0	←	14.0	28.0	56.0	84.0
Heating kW	11.0	←	16.0	31.5	64.0	95.0
<b>Electrical Data</b>						
Voltage, Frequency, Phase	V-, Hz, Ph	380, 50, 3	220-240, 50, 1	380, 50, 3	←	←
<b>Performance</b>						
Air Flow Volume	m <sup>3</sup> /h	5000	←	5000	10000	20000
Noise Level	dB(A)	54	←	54	58	60
<b>Dimension</b>						
Net Packing	WxHxD mm	990x960x360	←	←	997x1920x880	1992x1920x880
Weight	mm	1120x1090x435	←	←	1105x2120x1034	2110x2120x1034
Net	kg	101	←	←	245	520
Gross	kg	106	←	←	260	525
<b>Piping Connection</b>						
Max Length of pipe		60	←	←	150	←
Max Height Difference	Between indoor units	8	←	←	15	←
	Between indoor units and outdoor unit	20	←	←	50	←
<b>SystemMatch Configuration</b>						
Max Qty per 20'/40'/40'HQ	Pieces	1-drive-6 50/100/100	←	←	1-drive-8 10/20/20	1-drive-20 4/10/10

Remarks: 1.The above specifications are subject to change without prior notice for product improvement.  
2.The noise levels given in the table reflect the levels in anechoic chamber.

## Indoor Unit

Unit: x100W

Model	Refrigerant	Capacity	22	28	36	45	56	71	80	90	112	140	280
Four-way cassette (compact)	R410A R407C R22		•	•	•								
Four-way cassette	R410A R407C R22			•	•	•	•	•	•	•	•		
One-way cassette (compact)	R410A R407C R22		•	•									
One-way cassette	R410A R407C R22					•	•	•					
Low Static Pressure Duct	R410A R407C R22		•	•	•	•	•						
Duct	R410A R407C R22		•	•	•	•	•	•	•	•	•	•	•
High static pressure duct	R410A R407C R22					•	•	•	•	•	•	•	•
High static pressure duct	R410A R407C R22							•	•	•	•	•	•
Floor Standing	R410A R407C R22		•	•	•	•	•	•	•				
Concealed Floor Standing	R410A R407C R22		•	•	•	•	•	•	•				
Ceiling & floor	R410A R407C R22				•	•	•	•	•	•	•	•	•
Wall-mounted	R410A R407C R22		•	•	•	•	•						
Wall-mounted (compact)	R410A R407C R22		•	•	•	•	•						

• The Digital Scroll A/C System and Inverter Commercial A/C System have the same specification of indoor unit.



# Digital Scroll A/C System

Cooling & Heating

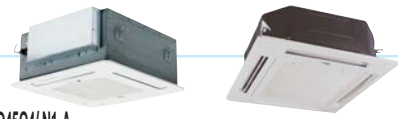

## Indoor Unit (Q4)

Model		MDV-D28Q4/N1-A MDV-D28Q4/(N2)-A	MDV-D36Q4/N1-A MDV-D36Q4/(N2)-A	MDV-D45Q4/N1-A MDV-D45Q4/(N2)-A	MDV-D28Q4/(N2)	MDV-D36Q4/(N2)
Capacity						
Cooling	kW	2.8	3.6	4.5	2.8	3.6
Heating	kW	3.2	4.0	5.0	3.2	4.0
Electrical Data						
Voltage, Frequency, Phase	V-, Hz, Ph	220-240, 50, 1	←	←	←	←
Performance						
Air Flow Volume	m <sup>3</sup> /h	780	←	←	870	←
Noise Level	dB(A)	36	←	←	←	←
Dimension						
Net	WxHxD	580x254x580	←	←	840x240x840	←
Packing	Body	650x30x650	←	←	950x40x950	←
	Panel	795x340x745	←	←	955x255x955	←
Weight	Net	22/3	←	←	25/6	←
	Gross	29/5	←	←	32/11	←
Qty per 20'/40'/40'HQ	Indoor Pieces	110/245/252	←	←	72/145/168	←

Model		MDV-D45Q4/(N2)	MDV-D56Q4/N1 MDV-D56Q4/(N2)	MDV-D71Q4/N1 MDV-D71Q4/(N2)	MDV-D80Q4/N1 MDV-D80Q4/(N2)	MDV-D90Q4/N1 MDV-D90Q4/(N2)	MDV-D112Q4/N1 MDV-D112Q4/(N2)
Capacity							
Cooling	kW	4.5	5.6	7.1	8.0	9.0	11.2
Heating	kW	5.0	6.3	8.0	9.0	10.0	12.5
Electrical Data							
Voltage, Frequency, Phase	V-, Hz, Ph	220-240, 50, 1	←	←	←	←	←
Performance							
Air Flow Volume	m <sup>3</sup> /h	1050	←	←	←	1600	←
Noise Level	dB(A)	38	←	42	←	44	←
Dimension							
Net	WxHxD	840x240x840	←	←	←	840x310x840	←
Packing	Body	950x40x950	←	←	←	←	←
	Panel	955x255x955	←	←	←	955x325x955	←
Weight	Net	28/6	←	←	←	35/6	←
	Gross	34/11	←	←	←	41/11	←
Qty per 20'/40'/40'HQ	Indoor Pieces	72/145/168	←	←	←	56/126/144	←

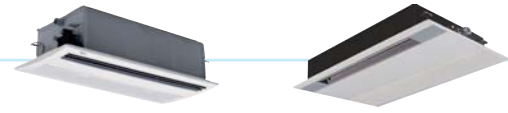

## Indoor Unit (Q1)

Model		MDV-D28Q1/BN1 MDV-D28Q1/B(N2)	MDV-D36Q1/BN1 MDV-D36Q1/B(N2)	MDV-D45Q1/BN1 MDV-D45Q1/B(N2)	MDV-D56Q1/BN1 MDV-D56Q1/B(N2)	MDV-D71Q1/BN1 MDV-D71Q1/B(N2)
Capacity						
Cooling	kW	2.8	3.6	4.5	5.6	7.1
Heating	kW	3.2	4.0	5.0	6.3	8.0
Electrical Data						
Voltage, Frequency, Phase	V-, Hz, Ph	220-240, 50, 1	←	←	←	←
Performance						
Air Flow Volume	m <sup>3</sup> /h	470	500	780	←	1080
Noise Level	dB(A)	35	36	42	←	←
Dimension						
Net	WxHxD	850x235x400	←	1200x198x655	←	←
Packing	Body	1050x18x470	←	1420x10x755	←	←
	Panel	1080x310x460	←	1380x265x775	←	←
Weight	Net	23/4	←	31/9	←	←
	Gross	27/7	←	38/12	←	←
Qty per 20'/40'/40'HQ	Indoor Pieces	115/238/268	←	69/145/165	←	←

Remarks: 1.The above specifications are subject to change without prior notice for product improvement.  
2.The noise levels given in the table reflect the levels in anechoic chamber.



## Indoor Unit (T3)

Model		MDV-D22T3/N1 MDV-D22T3/(N2)	MDV-D28T3/N1 MDV-D28T3/(N2)	MDV-D36T3/N1 MDV-D36T3/(N2)	MDV-D45T3/N1 MDV-D45T3/(N2)	MDV-D56T3/N1 MDV-D56T3/(N2)
Capacity						
Cooling	kW	2.2	2.8	3.6	4.5	5.6
Heating	kW	2.6	3.2	4.0	5.0	6.3
Electrical Data						
Voltage, Frequency, Phase	V-, Hz, Ph	220-240, 50, 1	←	←	←	←
Performance						
Air Flow Volume	m <sup>3</sup> /h	580	←	←	950	←
External static pressure	Pa	10	←	←	←	←
Noise Level	dB(A)	34	35	←	37	←
Dimension						
Net	WxHxD	955x210x385	←	←	1301x210x385	←
Packing	WxHxD	1114x277x469	←	←	1459x277x469	←
Weight						
Net	kg	15	←	←	18	←
Gross	kg	19	←	←	22	←
Qty per 20'/40'/40'HQ	Indoor Pieces	214/437/480	←	←	164/315/391	←

## Indoor Unit (T2)

Model		MDV-D22T2/N1 MDV-D22T2/(N2)	MDV-D28T2/N1 MDV-D28T2/(N2)	MDV-D36T2/N1 MDV-D36T2/(N2)	MDV-D45T2/N1-A3 MDV-D45T2/(N2)-A3	MDV-D56T2/N1-A3 MDV-D56T2/(N2)-A3
Capacity						
Cooling	kW	2.2	2.8	3.6	4.5	5.6
Heating	kW	2.6	3.2	4.0	5.0	6.3
Electrical Data						
Voltage, Frequency, Phase	V-, Hz, Ph	220-240, 50, 1	←	←	←	←
Performance						
Air Flow Volume	m <sup>3</sup> /h	750	←	←	1160	←
External static pressure	Pa	40	←	←	←	←
Noise Level	dB(A)	34	35	←	38	←
Dimension						
Net	WxHxD	800x320x550	←	←	1000x298x800	←
Packing	WxHxD	930x420x755	←	←	1200x370x930	←
Weight						
Net	kg	26	←	←	46	←
Gross	kg	34	←	←	54	←
Qty per 20'/40'/40'HQ	Indoor Pieces	61/134/164	←	←	60/140/164	←

Model		MDV-D71T2/N1-A3 MDV-D71T2/(N2)-A3	MDV-D80T2/N1-A3 MDV-D80T2/(N2)-A3	MDV-D90T2/N1-A3 MDV-D90T2/(N2)-A3	MDV-D112T2/N1-A3 MDV-D112T2/(N2)-A3	MDV-D140T2/N1-A3 MDV-D140T2/(N2)-A3	MDV-D280T2/N1 MDV-D280T2/(N2)
Capacity							
Cooling	kW	7.1	8.0	9.0	11.2	14.0	28.0
Heating	kW	8.0	9.0	10.0	12.5	16.0	31.0
Electrical Data							
Voltage, Frequency, Phase	V-, Hz, Ph	220-240, 50, 1	←	←	←	←	←
Performance							
Air Flow Volume	m <sup>3</sup> /h	1460	←	2070	←	2400	4400
External static pressure	Pa	40	←	70	←	←	96
Noise Level	dB(A)	42	←	44	←	46	49
Dimension							
Net	WxHxD	1000x298x800	←	1350x298x800	←	←	1350x450x760
Packing	WxHxD	1200x370x930	←	1555x370x930	←	←	1600x700x1010
Weight							
Net	kg	47	←	60	←	←	99
Gross	kg	55	←	70	←	←	109
Qty per 20'/40'/40'HQ	Indoor Pieces	60/140/164	←	48/100/112	←	←	22/48/48

Remarks: 1.The above specifications are subject to change without prior notice for product improvement.  
2.The noise levels given in the table reflect the levels in anechoic chamber.

# Digital Scroll A/C System

Cooling & Heating



## Indoor Unit (T1)

Model	MDV-D45T1/N1-A3 MDV-D45T1/(N2)-A3		MDV-D56T1/N1-A3 MDV-D56T1/(N2)-A3		MDV-D71T1/N1-A3 MDV-D71T1/(N2)-A3		MDV-D80T1/N1-A3 MDV-D80T1/(N2)-A3		MDV-D90T1/N1-A3 MDV-D90T1/(N2)-A3		MDV-D112T1/N1-A3 MDV-D112T1/(N2)-A3		MDV-D140T1/N1-A MDV-D140T1/(N2)-A		
	Capacity														
Cooling	kW	4.5	5.6	7.1	8.0	9.0	11.2	14.0							
Heating	kW	5.0	6.3	8.0	9.0	10.0	12.5	16.0							
Electrical Data															
Voltage, Frequency, Phase	V-, Hz, Ph	220-240, 50, 1	←												←
Performance															
Air Flow Volume	m <sup>3</sup> /h	1400	←		1550	←		2150	←		2500				
External static pressure	Pa	70	←												150
Noise Level	dB(A)	38	←		42	←		44	←		46				
Dimension															
Net	WxHxD	mm	1000x298x800	←		←	←		1350x298x800	←		1350x320x800			
Packing	WxHxD	mm	1200x370x930	←		←	←		1555x370x930	←		1555x440x930			
Weight															
Net	kg	38	←		40	←		50	←		72				
Gross	kg	45	←		47	←		59	←		82				
Qty per 20'/40'/40'HQ	Indoor	Pieces	60/140/164	←		←	←		48/100/112	←		36/84/98			

## Indoor Unit (T1)

Model	MDV-D71T1/N1 MDV-D71T1/(N2)		MDV-D80T1/N1 MDV-D80T1/(N2)		MDV-D90T1/N1 MDV-D90T1/(N2)		MDV-D112T1/N1 MDV-D112T1/(N2)		MDV-D140T1/N1 MDV-D140T1/(N2)		MDV-D280T1/N1 MDV-D280T1/(N2)			
	Capacity													
Cooling	kW	7.1	8.0	9.0	11.2	14.0	28.0							
Heating	kW	8.0	9.0	10.0	12.5	16.0	31.5							
Electrical Data														
Voltage, Frequency, Phase	V-, Hz, Ph	220-240, 50, 1	←										←	
Performance														
Air Flow Volume	m <sup>3</sup> /h	1300	←		2200	←		←	←		5000			
External static pressure	Pa	196	←										←	
Noise Level	dB(A)	44	←		47	←		←	←		50			
Dimension														
Net	WxHxD	mm	850x380x660	←		1200x380x660	←		←	←		1350x450x760		
Packing	WxHxD	mm	1075x473x775	←		1425x473x775	←		←	←		1600x700x1010		
Weight														
Net	kg	49	←		62	←		←	←		98			
Gross	kg	55	←		70	←		←	←		108			
Qty per 20'/40'/40'HQ	Indoor	Pieces	81/166/166	←		60/123/123	←		←	←		22/48/48		

## Indoor Unit (DL)

Model	MDV-D36DL/N1-B MDV-D36DL/(N2)-B		MDV-D45DL/N1-B MDV-D45DL/(N2)-B		MDV-D56DL/N1-B MDV-D56DL/(N2)-B		MDV-D71DL/N1-B MDV-D71DL/(N2)-B		MDV-D80DL/N1-B MDV-D80DL/(N2)-B		MDV-D90DL/N1-B MDV-D90DL/(N2)-B		MDV-D112DL/N1-B MDV-D112DL/(N2)-B		MDV-D140DL/N1-B MDV-D140DL/(N2)-B		
	Capacity																
Cooling	kW	3.6	4.5	5.6	7.1	8.0	9.0	11.2	14.0								
Heating	kW	4.0	5.0	6.3	8.0	9.0	10.0	12.5	16.0								
Electrical Data																	
Voltage, Frequency, Phase	V-, Hz, Ph	220-240, 50, 1	←														←
Performance																	
Air Flow Volume	m <sup>3</sup> /h	800	←		←	1000	1200	1400	1800	2000							
Noise Level	dB(A)	36	←		38	40	41	←	42								
Dimension																	
Net	WxHxD	mm	995x660x198	←		←	1285x660x198	←		1670x680x240							
Packing	WxHxD	mm	1080x740x290	←		←	1365x740x290	←		1760x760x330							
Weight																	
Net	kg	30	←		←	34	←	52									
Gross	kg	37	←		←	42	←	62									
Qty per 20'/40'/40'HQ	Indoor	Pieces	128/270/300	←		←	99/203/228	←		72/153/168							

Remarks: 1.The above specifications are subject to change without prior notice for product improvement.  
2.The noise levels given in the table reflect the levels in anechoic chamber.

Cooling & Heating



## Indoor Unit (F)

Model	MDV-D22F/N1 MDV-D22F/(N2)		MDV-D28F/N1 MDV-D28F/(N2)		MDV-D36F/N1 MDV-D36F/(N2)		MDV-D45F/N1 MDV-D45F/(N2)		MDV-D56F/N1 MDV-D56F/(N2)		MDV-D71F/N1 MDV-D71F/(N2)		MDV-D80F/N1 MDV-D80F/(N2)		
	Capacity														
Cooling	kW	2.2	2.8	3.6	4.5	5.6	7.1	8.0							
Heating	kW	2.6	3.2	4.0	5.0	6.3	8.0	9.0							
Electrical Data															
Voltage, Frequency, Phase	V-, Hz, Ph	220-240, 50, 1	←												←
Performance															
Air Flow Volume	m <sup>3</sup> /h	420	←		490	620	850	950	1050						
Noise Level	dB(A)	35	←		←	37	39	40	42						
Dimension															
Net	WxHxD	mm	1000x626x220	←		1200x626x220	←		1500x626x220	←		←			
Packing	WxHxD	mm	1145x810x285	←		1335x810x285	←		1645x810x285	←		←			
Weight															
Net	kg	38	←		43	←	55	←	←						
Gross	kg	42	←		47	←	60	←	←						
Qty per 20'/40'/40'HQ	Indoor	Pieces	80/168/252	←		68/138/216	←		54/114/171	←		←			

## Indoor Unit (F)

Model	MDV-D22F/N1-A MDV-D22F/(N2)-A		MDV-D28F/N1-A MDV-D28F/(N2)-A		MDV-D36F/N1-A MDV-D36F/(N2)-A		MDV-D45F/N1-A MDV-D45F/(N2)-A		MDV-D56F/N1-A MDV-D56F/(N2)-A		MDV-D71F/N1-A MDV-D71F/(N2)-A		MDV-D80F/N1-A MDV-D80F/(N2)-A		
	Capacity														
Cooling	kW	2.2	2.8	3.6	4.5	5.6	7.1	8.0							
Heating	kW	2.6	3.2	4.0	5.0	6.3	8.0	9.0							
Electrical Data															
Voltage, Frequency, Phase	V-, Hz, Ph	220-240, 50, 1	←												←
Performance															
Air Flow Volume	m <sup>3</sup> /h	420	←		490	620	850	950	1050						
Noise Level	dB(A)	35	←		←	37	39	40	42						
Dimension															
Net	WxHxD	mm	750x545x212	←		950x545x212	←		1250x545x212	←		←			
Packing	WxHxD	mm	835x630x265	←		1035x630x265	←		1335x630x265	←		←			
Weight															
Net	kg	35	←		39	←	50	←	←						
Gross	kg	39	←		44	←	55	←	←						
Qty per 20'/40'/40'HQ	Indoor	Pieces	91/182/282	←		73/155/236	←		59/134/192	←		←			

Remarks: 1.The above specifications are subject to change without prior notice for product improvement.  
2.The noise levels given in the table reflect the levels in anechoic chamber.

# Digital Scroll A/C System

Cooling & Heating



## Indoor Unit (G)

Model	MDV-D22G/N1-E		MDV-D28G/N1-E		MDV-D36G/N1-E		MDV-D45G/N1-E		MDV-D56G/N1-E		
	MDV-D22G(N2)-E		MDV-D28G(N2)-E		MDV-D36G(N2)-E		MDV-D45G(N2)-E		MDV-D56G(N2)-E		
<b>Capacity</b>											
Cooling		2.2		2.8		3.6		4.5		5.6	
Heating		2.5		3.2		4.0		5.0		6.3	
<b>Electrical Data</b>											
Voltage, Frequency, Phase	V-, Hz, Ph	220-240, 50, 1		←		←		←		←	
<b>Performance</b>											
Air Flow Volume	m <sup>3</sup> /h	580		←		←		850		←	
Noise Level	dB(A)	34		←		←		37		←	
<b>Dimension</b>											
Net	WxHxD	mm		←		←		920x292x225		←	
Packing	WxHxD	mm		←		←		1015x368x295		←	
<b>Weight</b>											
Net		kg		←		←		13		←	
Gross		kg		←		←		15		←	
Qty per 20'/40'/40'HQ	Indoor	Pieces		←		←		288/578/653		←	



## Indoor Unit (G)

Model	MDV-D22G/N1-A		MDV-D28G/N1-A		MDV-D36G/N1-A		MDV-D45G/N1-A		MDV-D56G/N1-A		
	MDV-D22G(N2)-A		MDV-D28G(N2)-A		MDV-D36G(N2)-A		MDV-D45G(N2)-A		MDV-D56G(N2)-A		
<b>Capacity</b>											
Cooling		2.2		2.8		3.6		4.5		5.6	
Heating		2.5		3.2		4.0		5.0		6.3	
<b>Electrical Data</b>											
Voltage, Frequency, Phase	V-, Hz, Ph	220-240, 50, 1		←		←		←		←	
<b>Performance</b>											
Air Flow Volume	m <sup>3</sup> /h	560		←		←		670		←	
Noise Level	dB(A)	36		←		←		46		←	
<b>Dimension</b>											
Net	WxHxD	mm		←		←		1080x330x222		←	
Packing	WxHxD	mm		←		←		1315x445x320		←	
<b>Weight</b>											
Net		kg		←		←		17		←	
Gross		kg		←		←		23		←	
Qty per 20'/40'/40'HQ	Indoor	Pieces		←		←		151/324/384		←	

Remarks: 1.The above specifications are subject to change without prior notice for product improvement.  
2.The noise levels given in the table reflect the levels in anechoic chamber.

# MDV [V] Series



## Inverter A/C System(DC/AC)

